

Technical Graphics

- Section Views
- Conventional Practice

Section Views

- Show Internal Detail

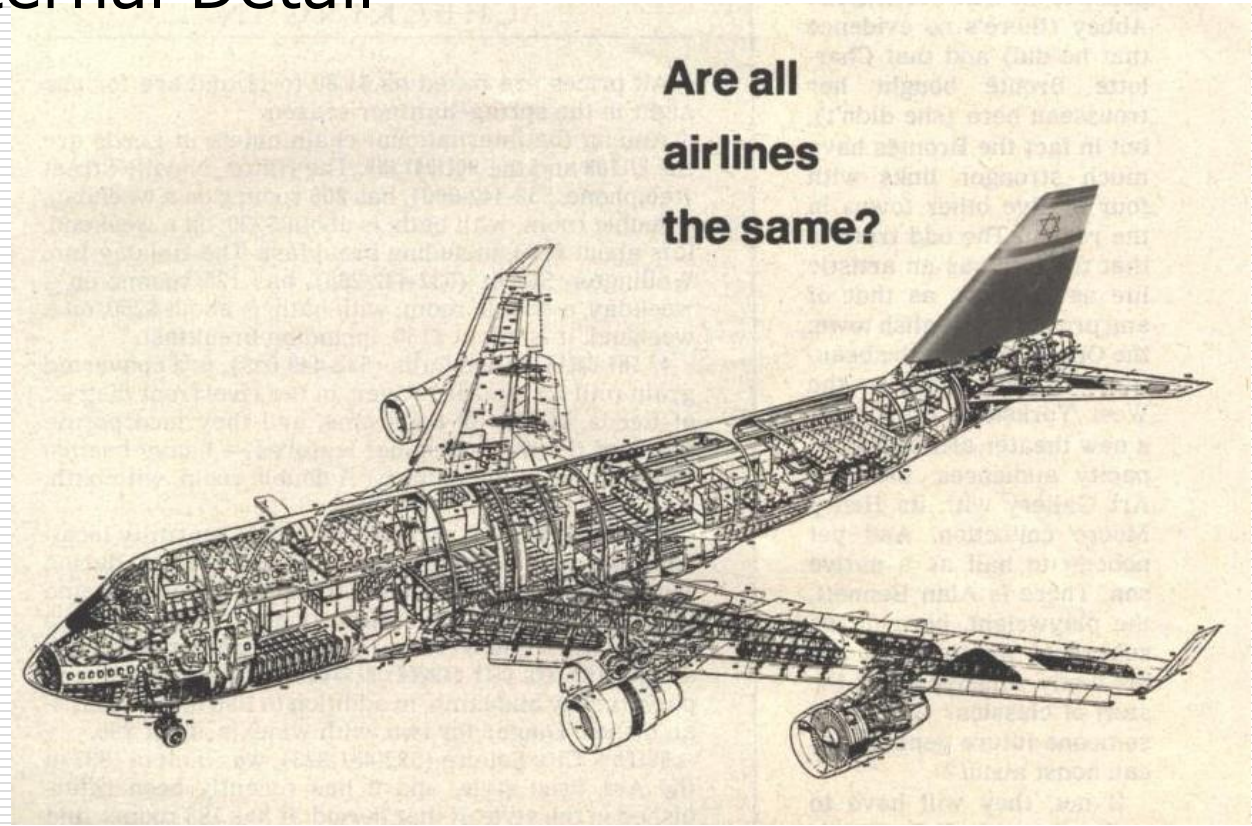

Section Views

- Identify section types
- Draw sections
- Study examples in text.
- References:
 - Engineering Graphics, Communication, Analysis, Creative Design, Sixth Edition, by Paul DeJong ,etal. (note: EG)

Cutting Planes and Sections Produced

- Note:
 - Section
 - Cutting Plane
- Reference:
 - EG: Fig 15.2.

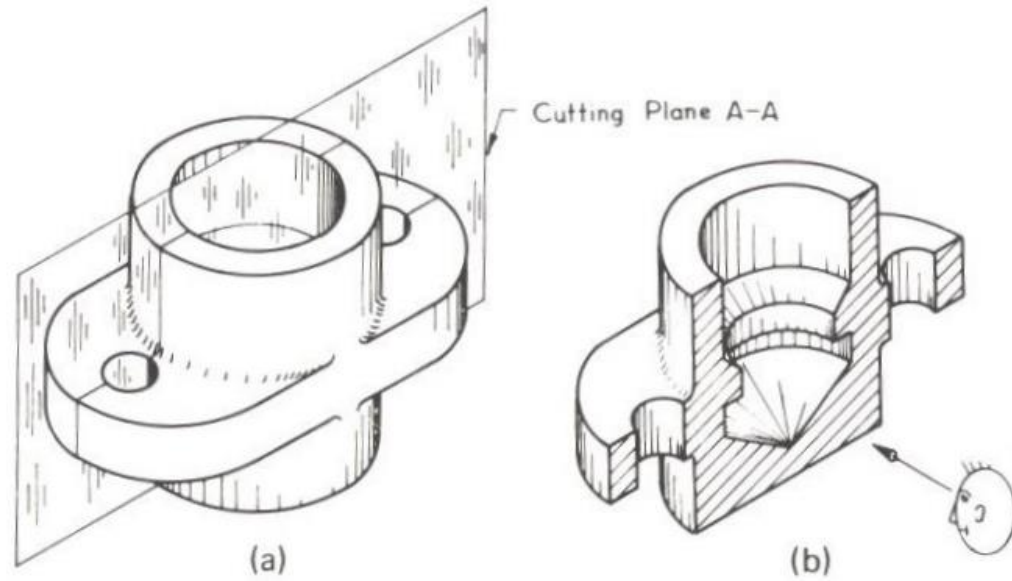

Section Views - Basic

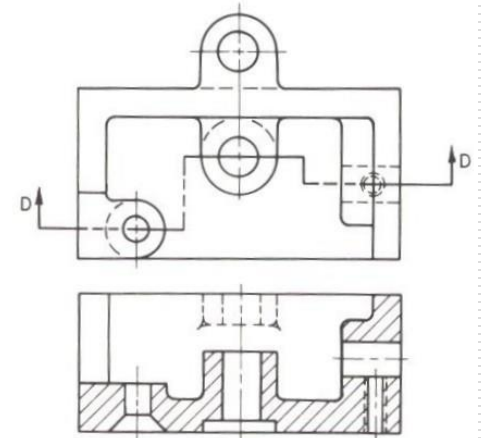
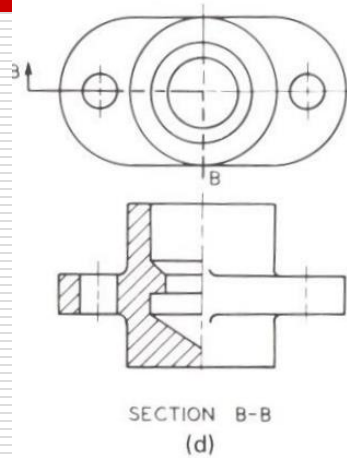
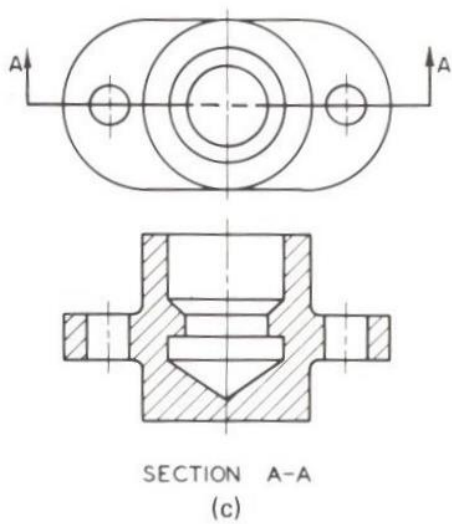

Section Views - Other

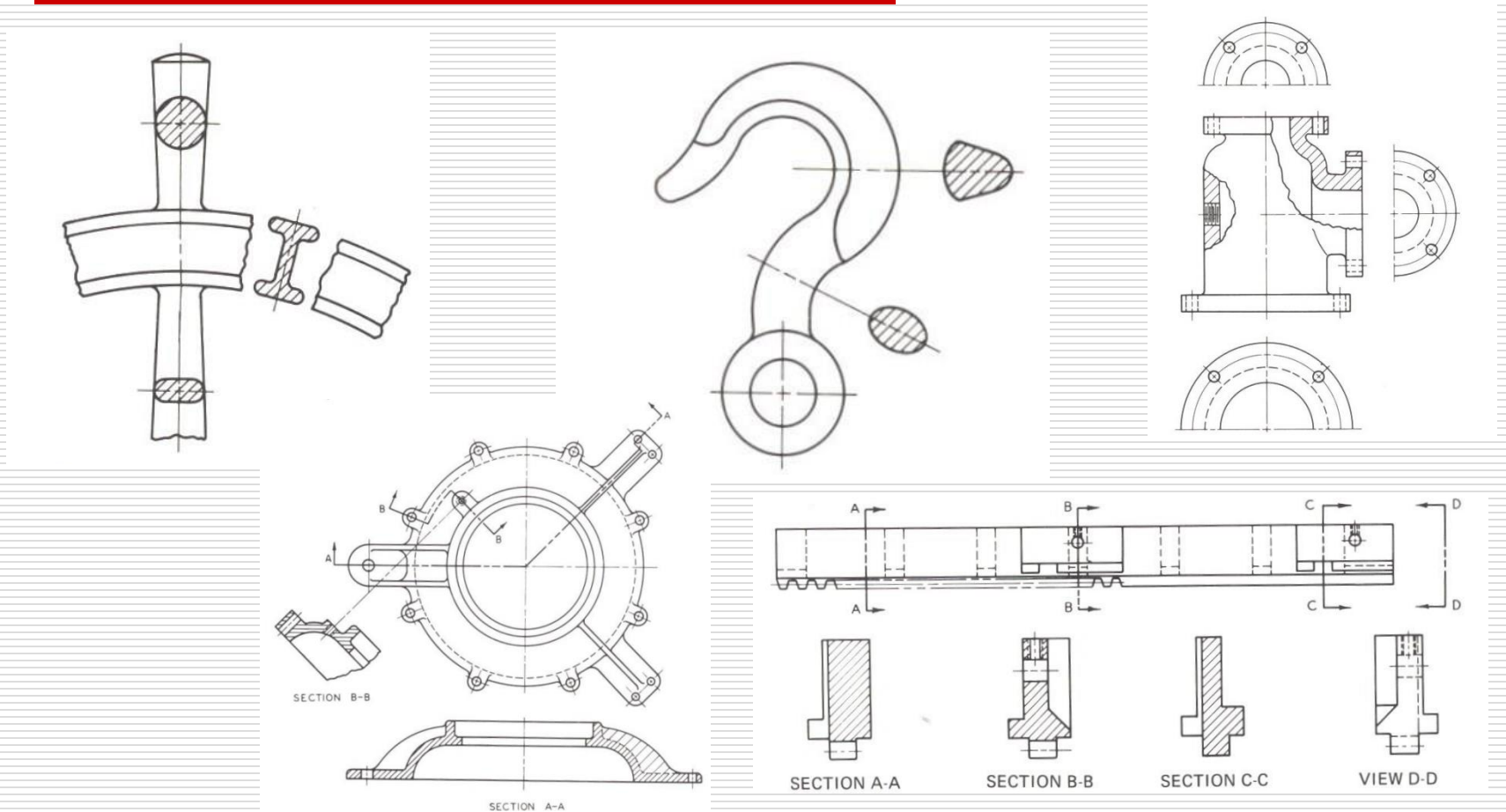

Gr 1.12a

COMPLETE THE GIVEN DRAWINGS WITH APPROPRIATE SECTIONS.

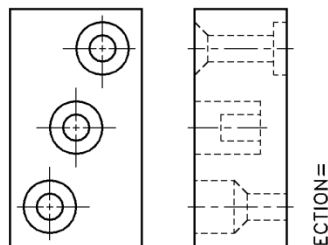
3.  SECTION =

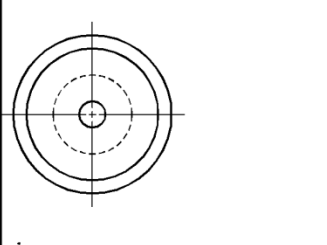
6.  SECTION =

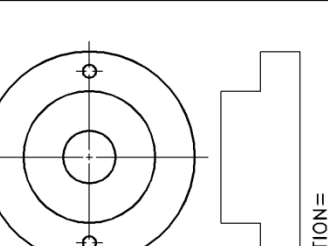
2.  SECTION =

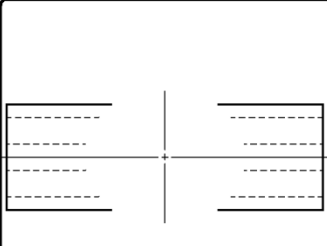
5.  SECTION =

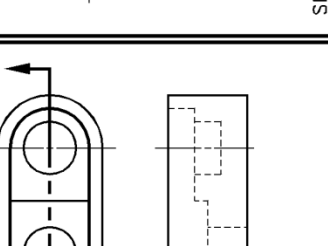
1.  SECTION =

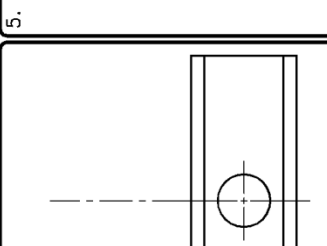
4.  SECTION =

NOTES: Section Views

DATE:	TITLE: Section Views	PAGE	OF
NO.:	INSTR.: jcs	DR. BY:	PROB. GRADE
SEC.:			1-12a
			REV. NO.: 09-0818

Identify / Draw Basic Section

(Re. Gr 1.12a)

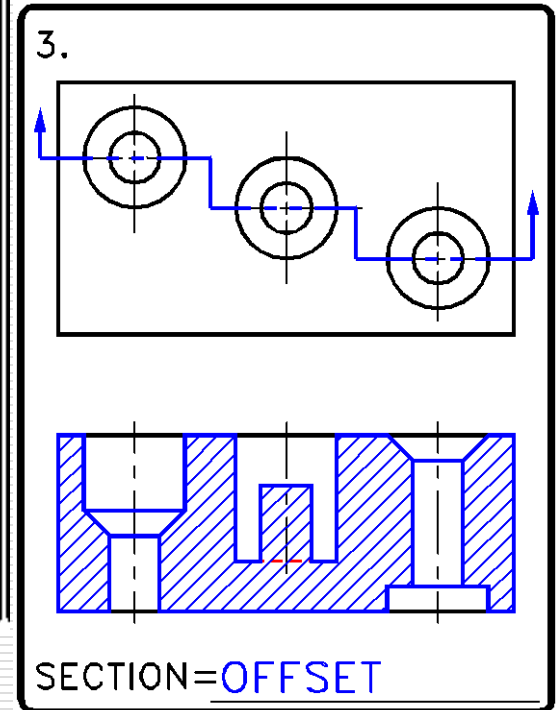
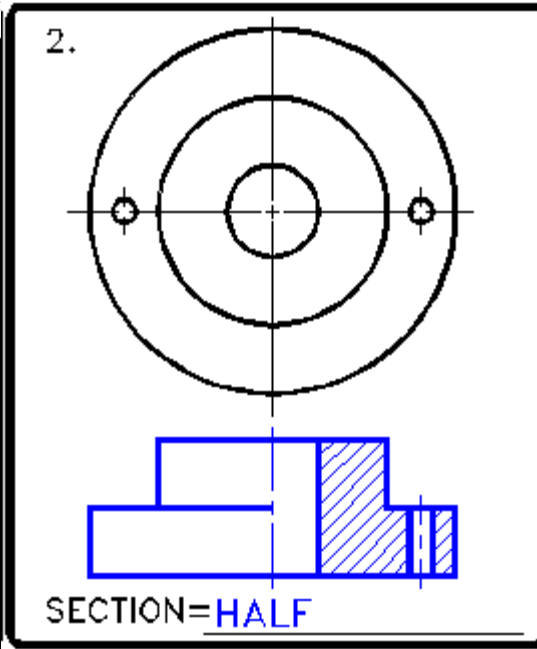
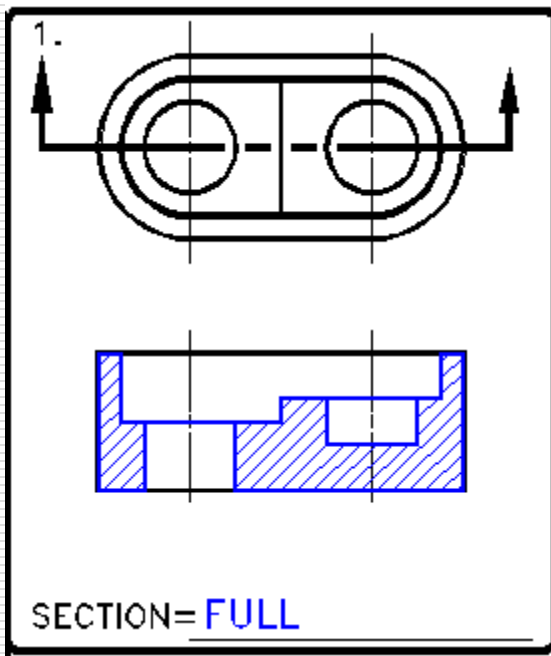

Identify / Draw Basic Section

(Gr 1.12a)

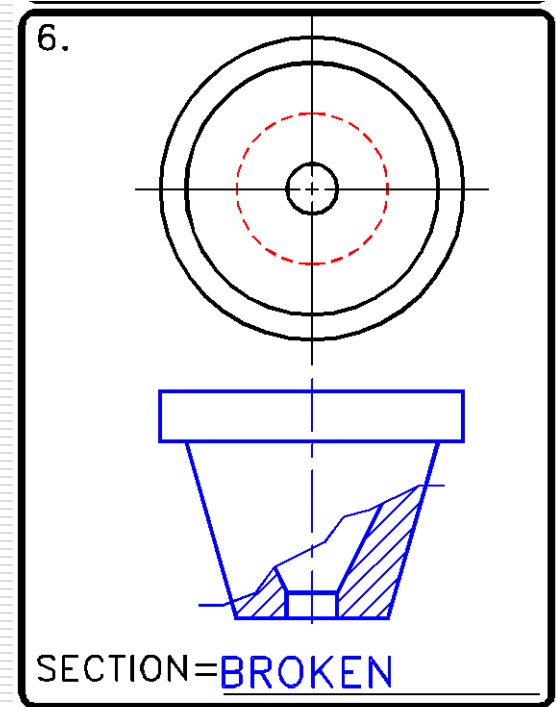
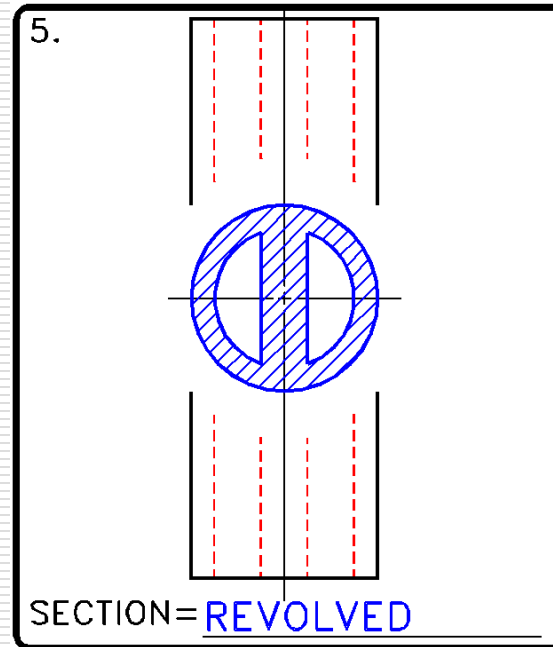
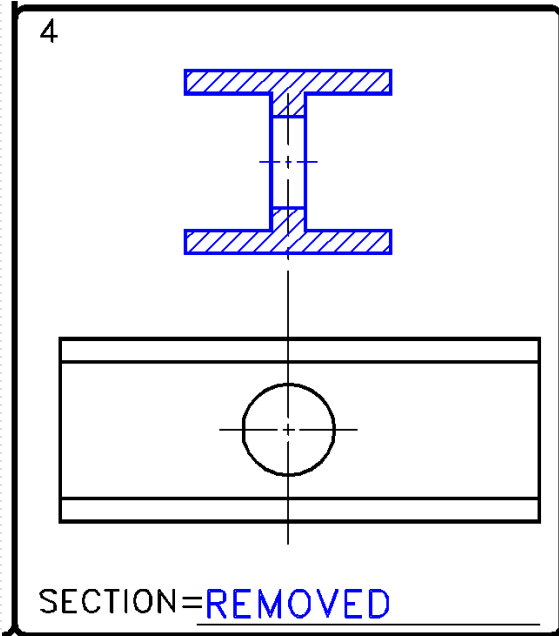

Gr 1.12b

□ Practice

1. Section View Type= _____

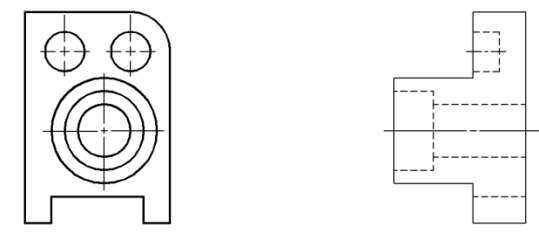

2. Section View Type= _____

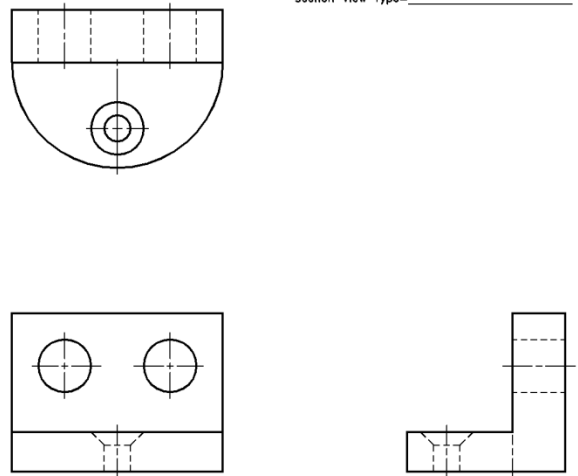

Finish the section views.

NOTES:

DATE:	SEC.:	TITLE: Section Views	PROB. GRADE
NO.:	INSTR.: jcs	DR. BY:	1.12b
			REV. NO.: 08-0818

Gr 1.12c

□ Practice

Section View / Conventional Practice Examples.

1.

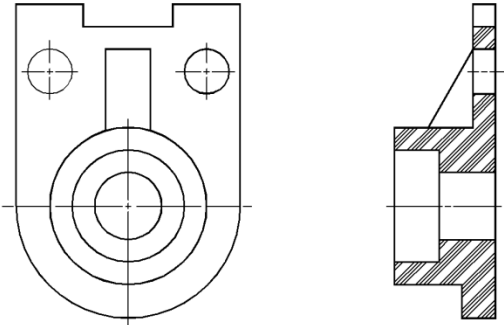

Section Type= _____
Conventional Practice= _____

2.

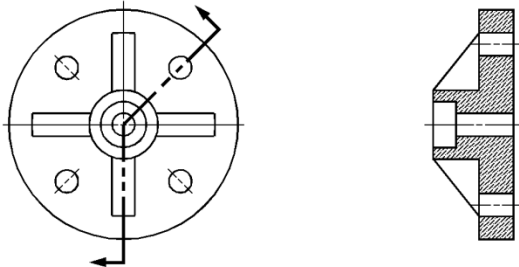

Section Type= _____
Conventional Practice= _____

NOTES:

DATE:	TITLE: Section Views	PROB. GRADE
NO.:	INSTR.: jcs	1.12c
SEC.:	DR. BY:	REV. NO.: 08-0818

Gr 1.12d

1. DRAW RIGHT VIEW AS A SECTION VIEW. SECTION TYPE= Aligned.

2. DRAW RIGHT VIEW (HALF SECTION), USE CONVENTIONAL PRACTICES.

NOTES:

DATE: _____ SEC.: _____ TITLE: Section views DR. BY: _____

NO.: _____ INSTR.: jcs _____

PROB. GRADE 1-12d

REV. NO.: 09-0818

Conventional Practices:
1. _____
2. _____

PAGE OF

CAD Examples

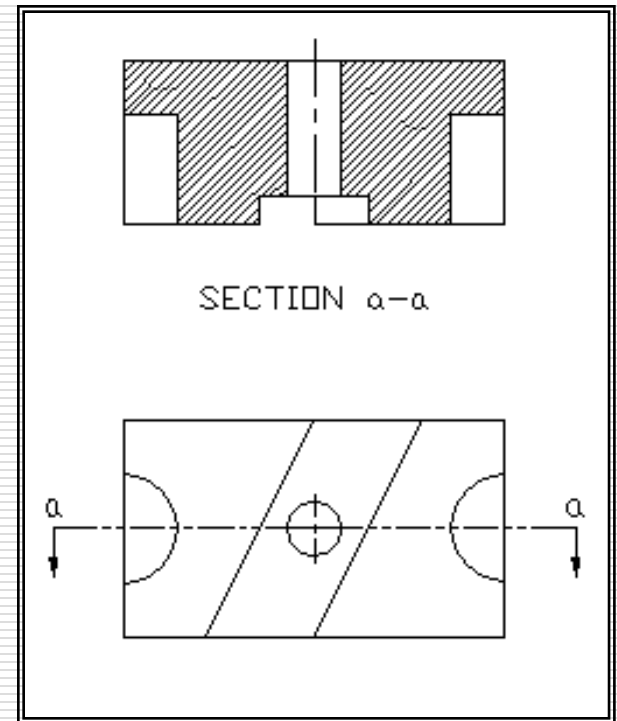
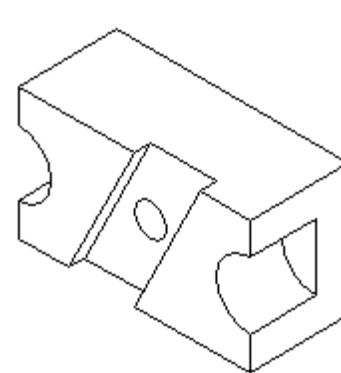
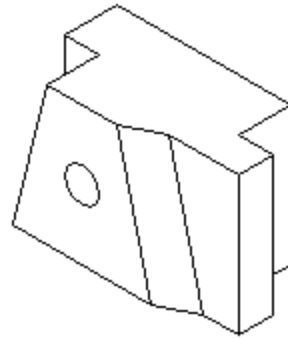
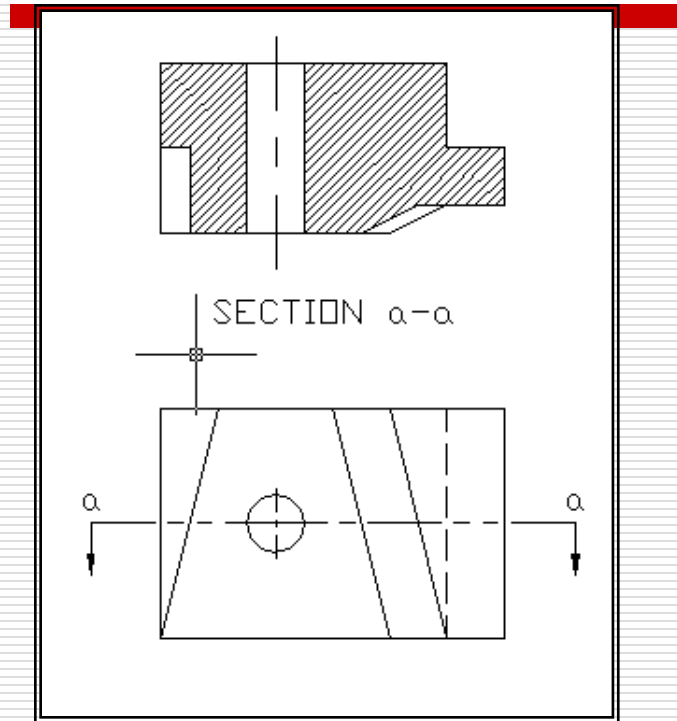

Re. Fundamentals of Graphics Communication, by Gary R. Beroline, et al.

CAD Examples

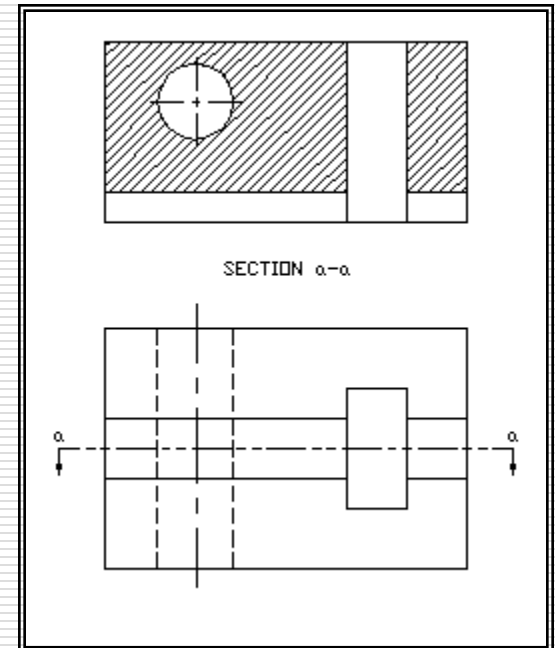
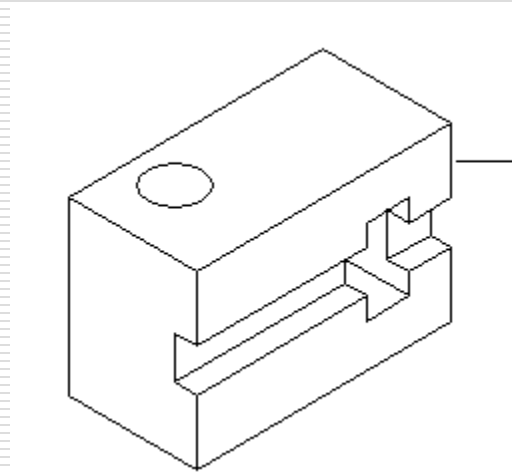
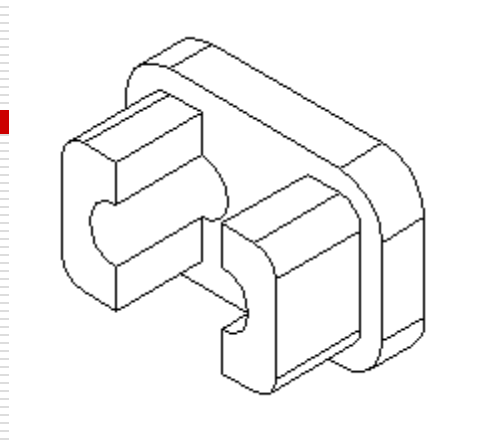
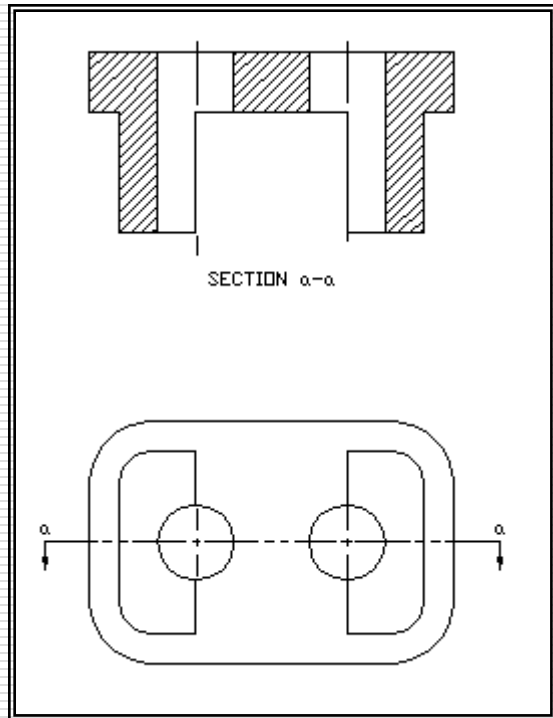

Re. Fundamentals of Graphics Communication, by Gary R. Beroline, etal.

CAD Examples

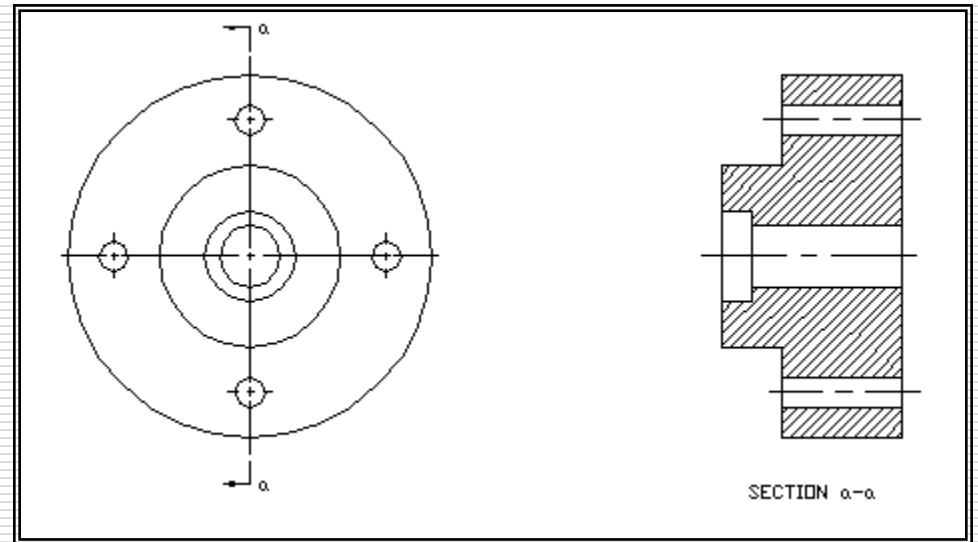
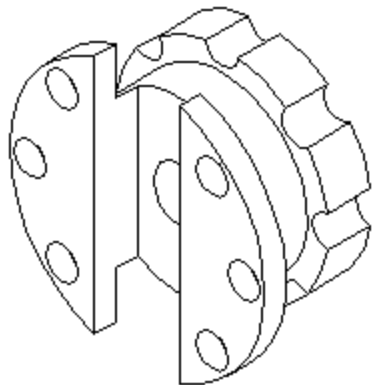
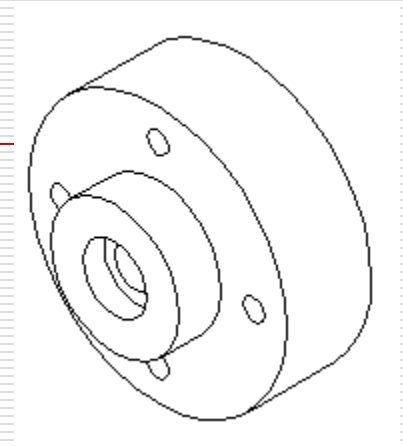
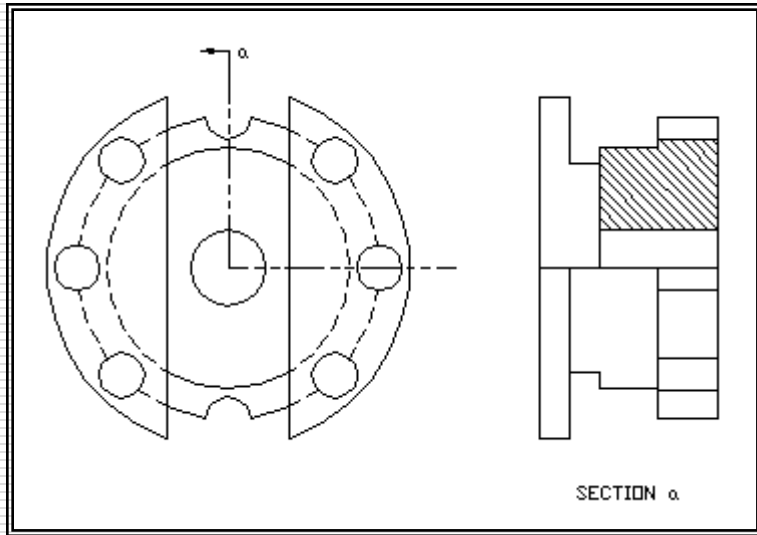

Re. Fundamentals of Graphics Communication, by Gary R. Beroline, etal.